

PLOT 7C - EXISTING NORTH ELEVATION

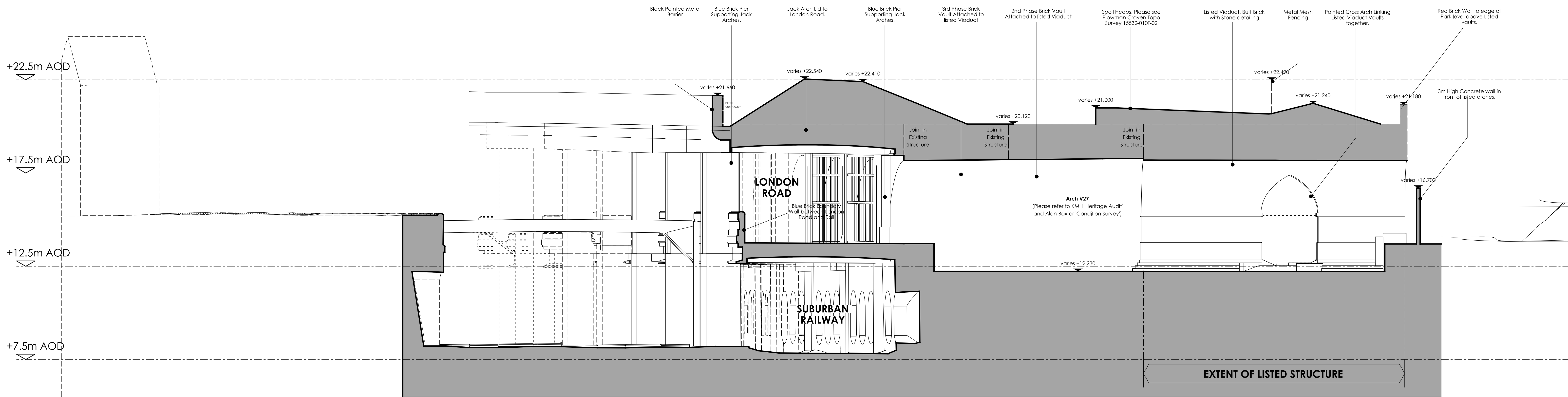

PLOT 7C - EXISTING EAST ELEVATION

**NOTE:**  
**REFER TO PLOWMAN CRAVEN SURVEY DRAWINGS:**

15532-010F-01 (A)	3D Street Survey
15532-010F-02 (B)	3D Site Topo
15532-010F-03 (A)	Boundary Drawing
15532-010W-02 (A)	Railway Cutting
15532-013E-03	North Elevation of Listed Archway
15532-013E-08	South Elevation of London Road
15532-013F-01 (B)	Planimetric Survey
W15532-010SM	3D Arch Survey

**FOR DETAIL OF ARCHES REFER TO:**

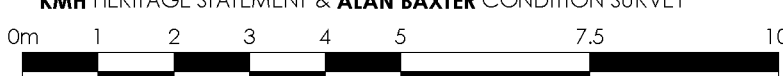

Do not scale this drawing

[illegible]